

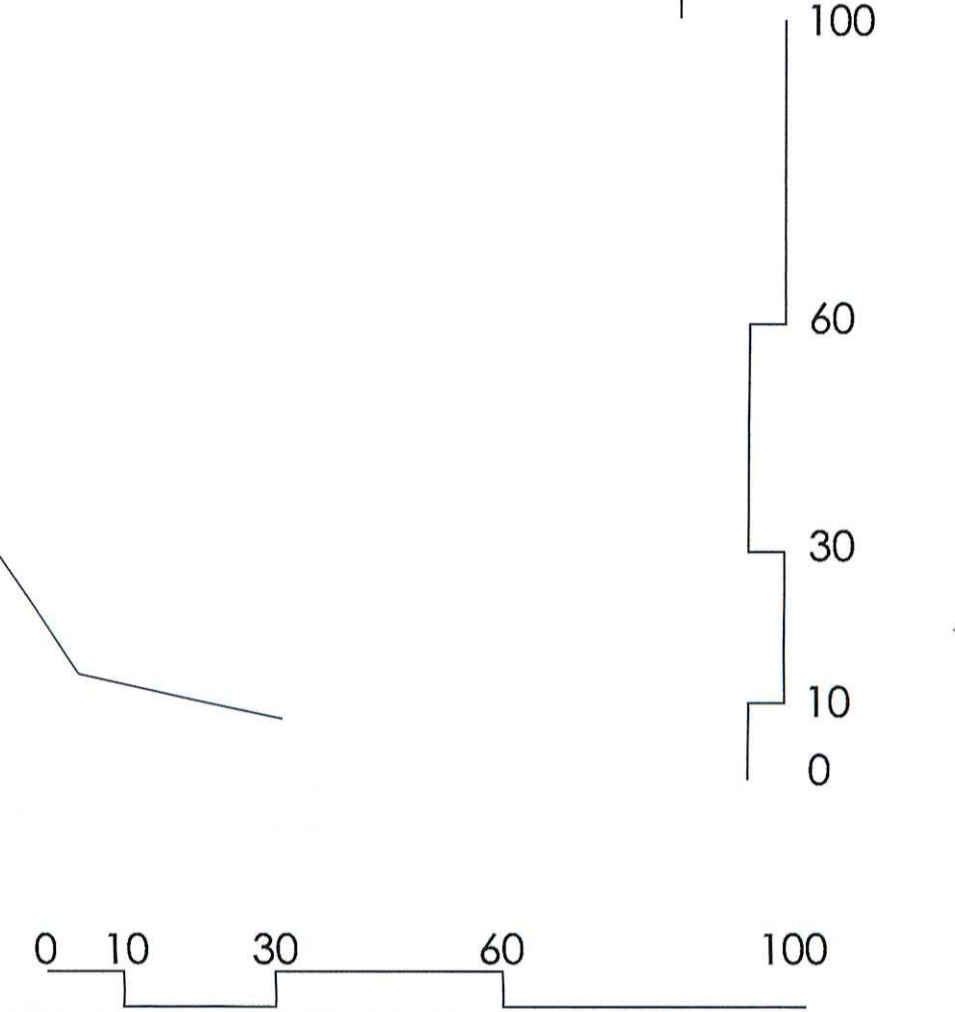

RECEIVED
11 FEB 2011

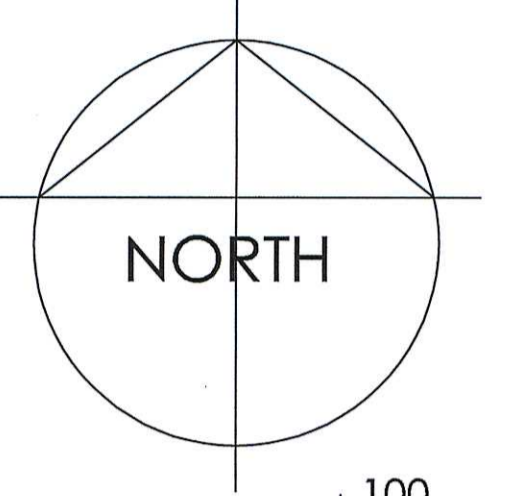

FOR PLANNING

- Rev H: 10.02.11 Fence detail references amended AM
 - Rev G: 18.01.11 Details of plant yard fence updated for clarification AM
 - Rev F: 11.01.11 Front boundary wall note revised CA
 - Rev E: 06.01.11 Boundary Details Clarified CA
 - Rev D: 18.10.10 Material Schedule added CA
 - Rev C: 13.04.10 Trees to be removed location illustrated DRW
 - Rev B: 27.01.10 Planning issue. NPA
 - Rev A: 04.11.09 Loading bay & landscaping amended. DW
- Revision: By Approved

Office 7, Gateway 1000
Arlington Business Park
Whittle Way
Stevenage
Hertfordshire
SG1 2FP

t: 01438 749400
f: 01438 749591
e: arc@archer.uk.com
www.archerarchitects.co.uk

Client:
TESCO EXPRESS

Project:
**Former HAPPY MAN PH
BERRY LANE, RICKMANSWORTH**

Drawing Title:
**PROPOSED SITE PLAN
REVISED BUILDING LINE**

Scale: 1:100@A1 Date: 18.10.10 Drawn: CA Checked: []
Project No: 3291 Drawing No: (P)1501 Revision: H

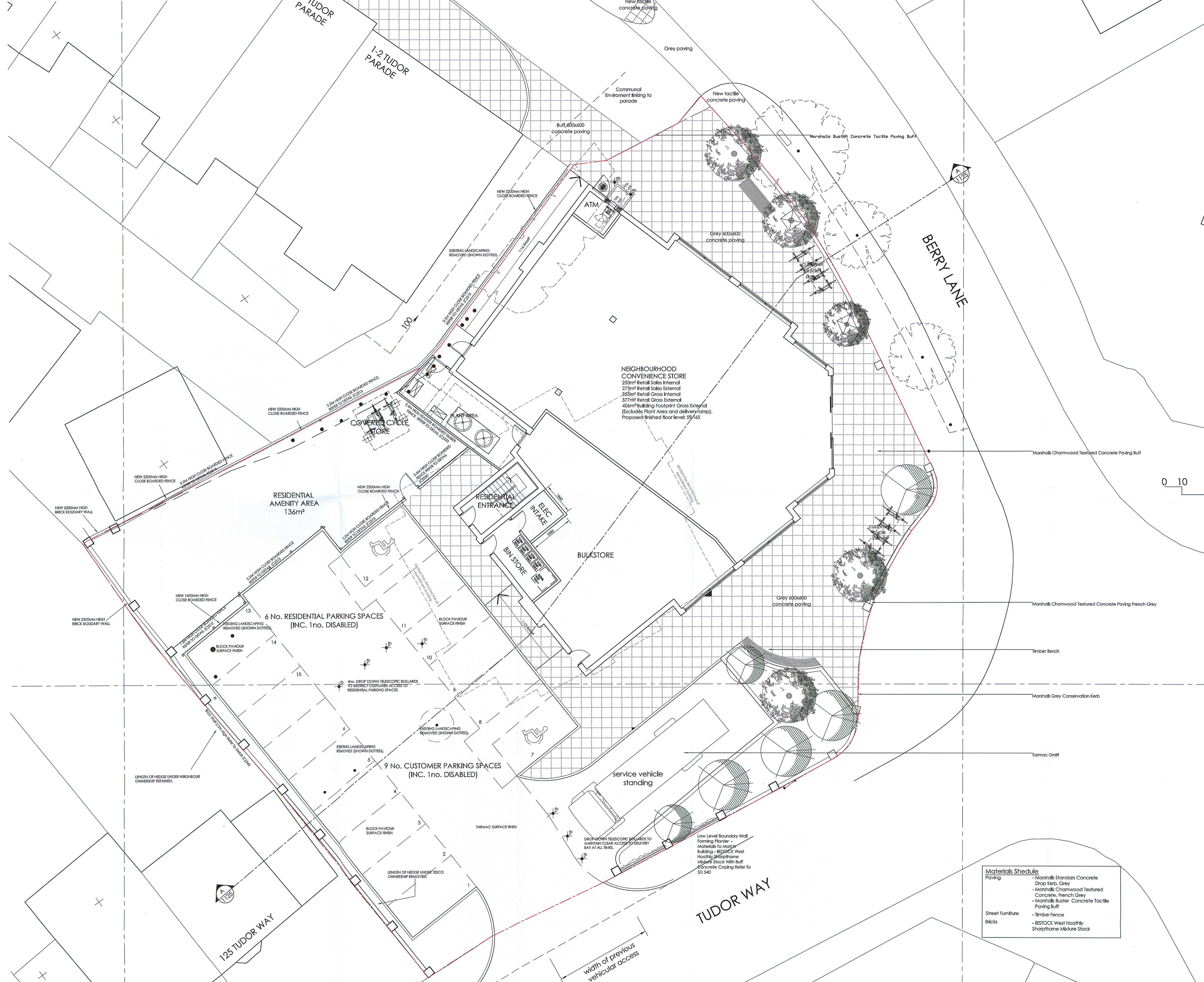

Materials Schedule

Paving	- Marshalls Standars Concrete
	- Drop Kerb, Grey
	- Marshalls Chamwood Textured Concrete, French Grey
	- Marshalls Buster Concrete Tactile Paving Buff
Street Furniture	- Timber Fence
Bricks	- IBSTOCK West Healthy Sharpstone Mixture Stock