

Amended

11

Moor Park Golf Club Rickmansworth

9 FEB 2009



THREE RIVERS D.C.
RECEIVED
- 6 JUL 2009
PLANNING DEPT.

09/0216
AMENDED
6.7.09

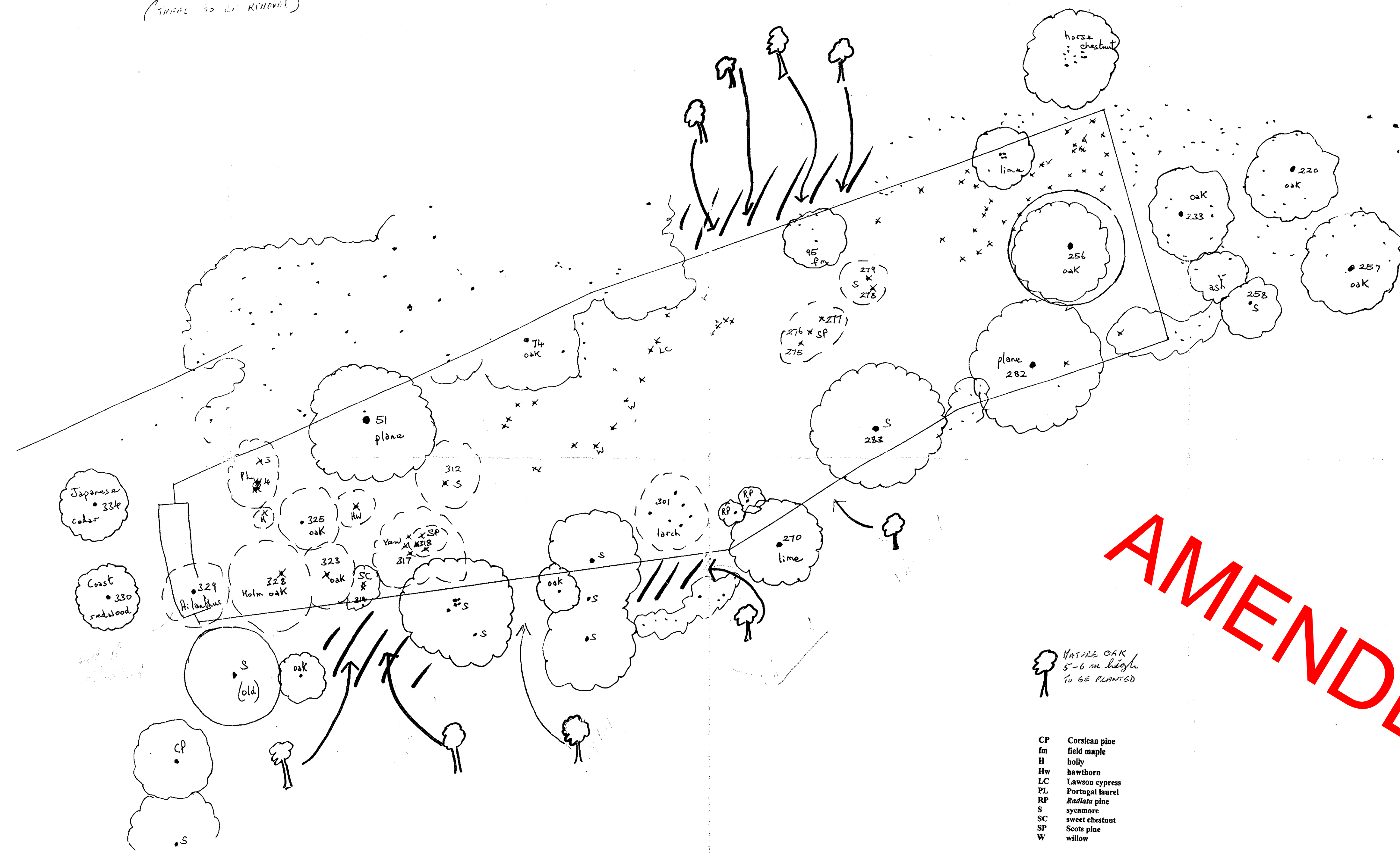
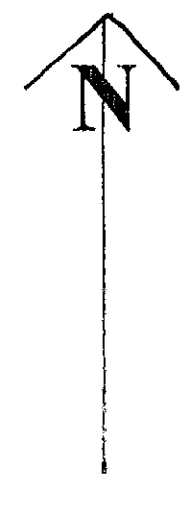
PROPOSED PRACTICE AREA
(PROPOSED FENCING)
&
(TREES TO BE REMOVED)



-  NATURAL OAK
5-6 m high
TO BE PLANTED
- CP Corsican pine
- fm field maple
- H holly
- Hw hawthorn
- LC Lawson cypress
- PL Portugal laurel
- RP Radialata pine
- S sycamore
- SC sweet chestnut
- SP Scots pine
- W willow
- x trees to be removed

-  Proposed fencing
-  Proposed planting

Scale 1:500 R Helliwell 30th July 2008

AMENDED